

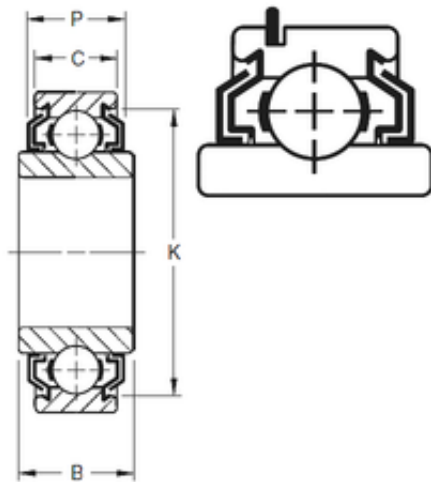

Bearing Power Machinery Co., Ltd.



Timken 200KLLG2 deep groove ball bearings

Bearing No. 200KLLG2

Size	10x30x16.4 mm
Bore Diameter	10 mm
Outer Diameter	30 mm
Width	16,4 mm
d	10 mm
D	30 mm
B	16,4 mm
C	8,99 mm
P	15,57 mm
K	25,4 mm
Weight	0,036 Kg
Basic dynamic load rating (C)	6,8 kN

200KLLG2 Bearing 2D drawings and 3D CAD models